

THIS DRAWING IS UNPUBLISHED. RELEASED FOR PUBLICATION .19
 (C) COPYRIGHT 19 BY AMP INCORPORATED. ALL RIGHTS RESERVED.

LOC		DIST		REVISIONS			
P	LTR	DESCRIPTION		DATE	DWN	APVD	
AA	20	L	REVISED; EC 0UF0-0130-01	28SEP01	DLD	EWB	

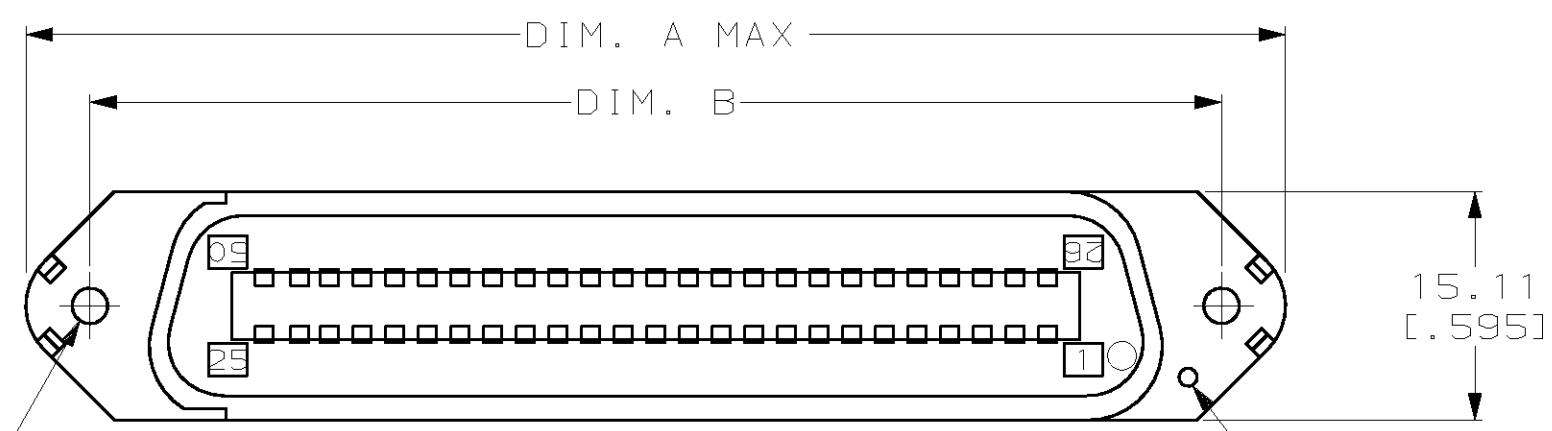

SEE TABLE FOR HOLE SIZE 2 HOLES

VIEW SHOWN WITH RETAINER REMOVED

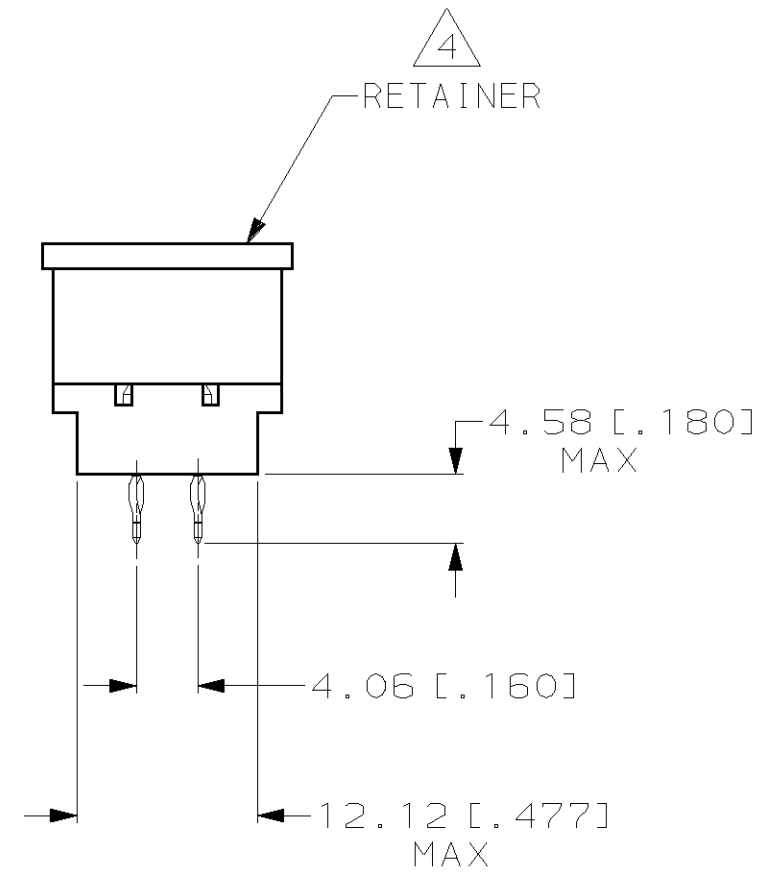

- 1 MATERIAL: HOUSING - POLYESTER MOLDING COMPOUND BLACK.
 TERMINAL - COPPER ALLOY PLATED WITH 0.76µm [.000030] MINIMUM THICK GOLD ON MATING SURFACE AND 0.13µm [.000005] MINIMUM THICK GOLD ON ACTION PIN AREA OVER 1.27µm [.000050] MINIMUM THICK NICKEL UNDERPLATE OVER ENTIRE TERMINAL.
 RETAINER - POLYETHYLENE, NATURAL.
- 2. THE CONTACT SURFACES OF THE TERMINALS ARE COATED WITH LUBRICANT.
- 3 ALL DIMENSIONS SHOWN ARE FOR REFERENCE ONLY UNLESS OTHERWISE SPECIFIED.
- 4 RETAINER MUST REMAIN INSTALLED UNTIL AFTER CONNECTOR HAS BEEN INSERTED INTO PCB HOLES.
- 5 OPTIONAL MOUNTING HOLE FOR SELF-TAPPING SCREW.
- 6. CENTER-TO-CENTER SPACING OF TERMINALS IS 2.16 [.085] NOMINAL.
- 7 ALL PLATED-THRU HOLES SHALL BE PER AMP SPEC 115-6072.
- 8 THRU HOLE ON HOUSING FLANGE INDICATES POSITION 1 LOCATION.

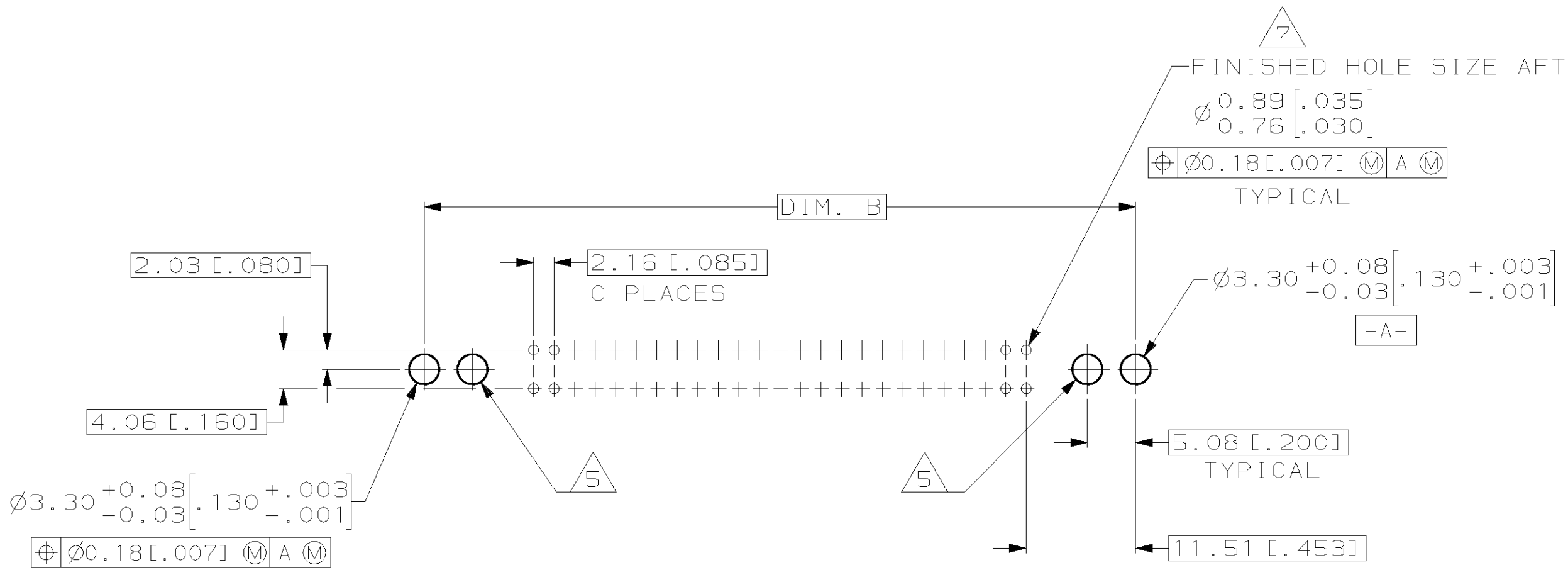

7 PRINTED CIRCUIT BOARD MOUNTING DIMENSIONS

31		89.97 [3.542]	98.43 [3.875]	64	553444-5
24	4-40 UNC-2B	74.83 [2.946]	83.31 [3.280]	50	553444-4
17		59.74 [2.352]	68.20 [2.685]	36	553444-3
11		46.79 [1.842]	55.25 [2.175]	24	553444-2
C		HOLE SIZE	DIM. B	DIM. A	POSITION

<small>THIS DRAWING IS A CONTROLLED DOCUMENT FOR AMP INCORPORATED. IT IS SUBJECT TO CHANGE AND THE CONTROLLING ENGINEERING ORGANIZATION SHOULD BE CONTACTED FOR THE LATEST REVISION.</small>		DWN A. HOLT 05 APR 85	AMP Incorporated Harrisburg, PA 17105-3608
DIMENSIONS: mm [INCHES]		CHK M. FRIEL 05 JUN 85	
TOLERANCES UNLESS OTHERWISE SPECIFIED: 0 PLC ±- 1 PLC ±- 2 PLC ±- 3 PLC ±- 4 PLC ±- ANGLES ±- FINISH ±-		APVD S. HEGE 05 JUN 85	
MATERIAL		NAME S. HEGE	
PRODUCT SPEC - APPLICATION SPEC - WEIGHT -		NAME PLUG ASSEMBLY, ACTION PIN, CHAMP-LOK	
CUSTOMER DRAWING		SIZE A2	RESTRICTED TO -
SCALE 2:1		CAGE CODE 00779	DRAWING NO 553444
SHEET 1 OF 1		REV L	

553444